

# Buying Guide: Tube & Wire Fittings

A Step-by-Step guide to help you find the right size and type of tube/wire fitting for any application

## 1 What Size do I need?

When buying any BPF tube & wire fittings the first thing you need to do is measure the tube that the fitting is for. Depending on which type of fitting you decide on there are 2 measurements you will need to know; the outside / external dimensions, and for internal fitting tube inserts you will also need to measure the wall thickness / gauge size.

### a: How to measure the outside dimensions

Measure the distance represented by the solid line to the **outside** of the tube/wire.

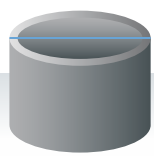

Round

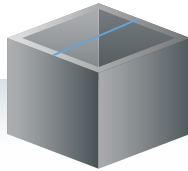

Square

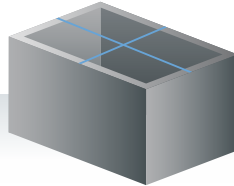

Rectangular

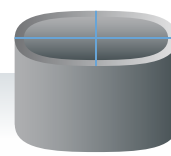

Oval

Vernier

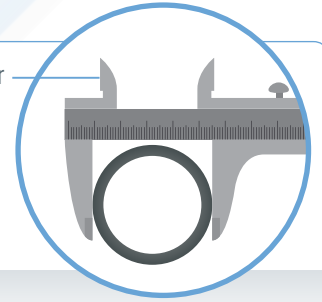

If you don't have a Vernier you can also use a ruler to measure the dimensions

### b: How to measure the wall thickness/gauge

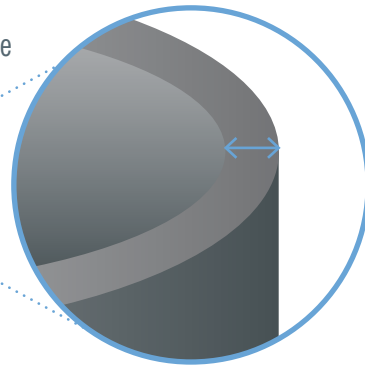
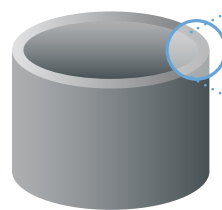

If the wall thickness of an insert isn't listed on our website then it's generally 1-2mm or 14/20 gauge

### BPF Conversion Chart:

Outside Tube Dimensions	
Imperial	mm
1/2"	12.7mm
5/8"	15.9mm
3/4"	19.1mm
7/8"	22.2mm
1"	25.4mm
1 1/8"	28.6mm
1 1/4"	31.8mm
1 3/8"	34.9mm
1 1/2"	38.1mm
1 5/8"	41.3mm
1 3/4"	44.5mm
1 29/32"	48.4mm
2"	50.8mm
2 1/4"	57.2mm
2 3/8"	60.3mm
2 1/2"	63.5mm
Wall Thickness/Gauge (SWG)	
Gauge	mm
8g	4.064mm
9g	3.658mm
10g	3.251mm
11g	2.946mm
12g	2.642mm
13g	2.337mm
14g	2.032mm
15g	1.829mm
16g	1.626mm
17g	1.422mm
18g	1.192mm
19g	1.016mm
20g	0.914mm

## 2 Tube Insert or External Fitting Ferrule?

When you know what size is needed the next step is to decide on which fitting you want. At BPF we offer the choice of internal fitting tube inserts or external fitting ferrules:

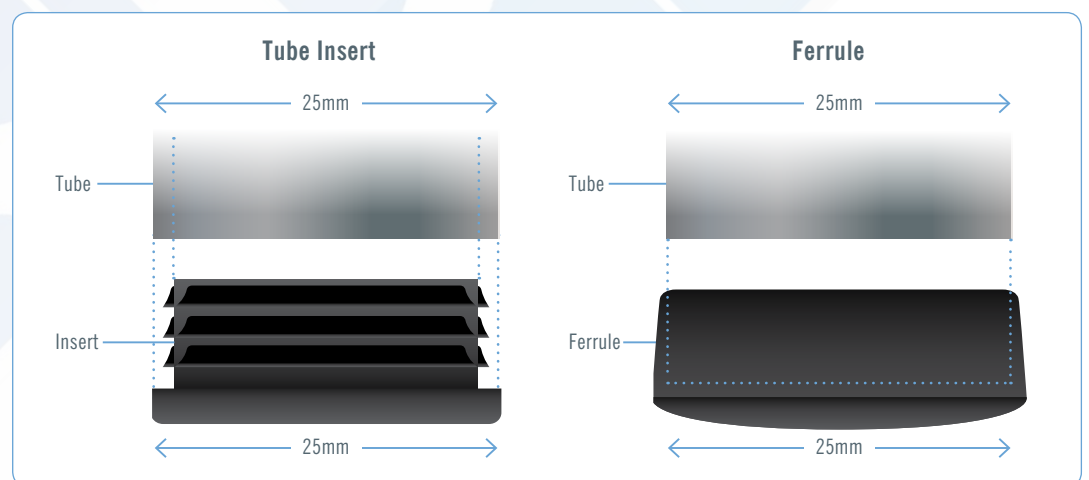

## 3 What type of fitting do I need?

The final thing to decide is which type of fitting you need. Here at we BPF we have a range of different Inserts and ferrules for various applications:

### Internal Fittings Tube Inserts:



#### Standard Flat Heads:

Ideal for situations where you just want to cap an end, or a tube is at 90 degrees to the floor.



#### Domed Heads:

Offers a cosmetic enhancement/detail, as well as offering an alternative to an angled insert.



#### Angled Heads:

Pre-Set angled ends, perfect for splayed legs or tubes where an angle is required.



#### Threaded/Tapped:

Similar to the flat headed insert but with a threaded hole, enabling you to add a foot, castor or glide.

### External Fitting Ferrules:



#### Standard Flat Heads:

Perfect for capping tube & projections, whilst offering a degree of protection to paintwork.

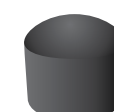

#### Domed Heads:

Can be used as a universal angled ferrule or cap, as well as offering a cosmetic enhancement.

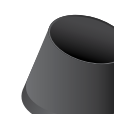

#### Angled Heads:

Pre-Set angled ends, perfect for splayed legs or tubes where an angle is required.